

Served by WEBSERVER-ONE

## SCOTTS BLUFF COUNTY, NEBRASKA

**Parcel**  
010004785  
Sale Date 4/3/1998  
Sale Price \$ 105,000  
Book & Page [215 -540](#)

**Name**  
COLEMAN WILLIAM F  
& MICHAEL A & TERESA COLEMAN  
40037 ORCHARD RD  
SCOTTSBLUFF NE 69361

**Legal**  
W 1/2 NW, 11-21-53 (80)  
140189 CR 33



**MIPS Inc.**  
[www.nebraskaassessorsonline.us](http://www.nebraskaassessorsonline.us)





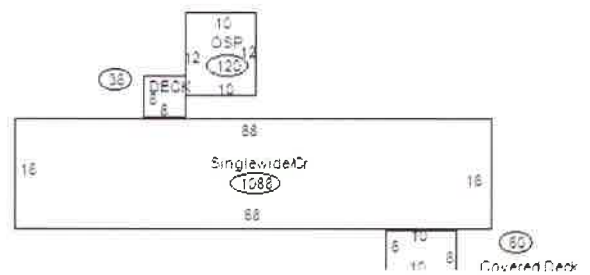
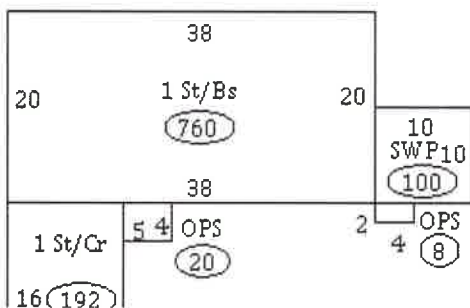
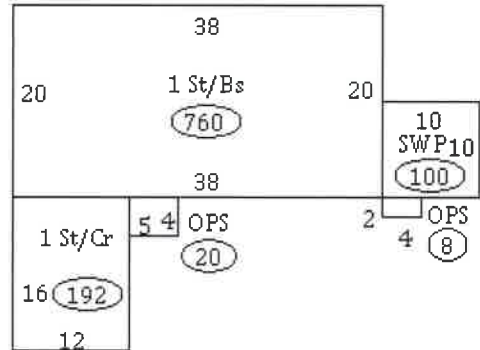
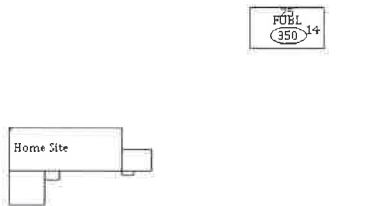

# Aerial Map



## Premier Properties

1942 East D Street  
Torrington, Wyoming  
888-532-4447  
www.wyo-realestate.com

Maps Provided By:



**11-21N-53W**  
**Scotts Bluff County**  
**Nebraska**

map center: 41° 48' 26.32, 103° 25' 50.65

scale: 9474

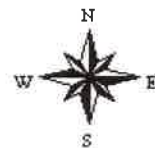

4/7/2014

Field borders provided by Farm Service Agency as of 5/21/2008. Aerial photography provided by Aerial Photography Field Office.